

Inline Orifice Kit (P/N 61371)

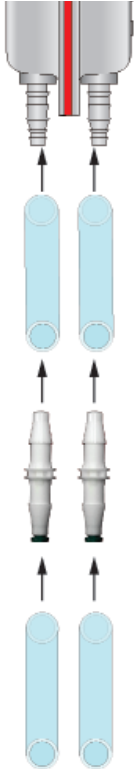

CONTENTS OF KIT:

- P/N 61370 Straight Tubing Adapter, white nylon, 3/16" ID
- Five Orifices as described below in Table 1
- Instruction bulletin LT-61371-00

1. USING AN AIR FLOW-RESTRICTING ORIFICE

Some applications require a delayed switching action after set point is reached. The delay is created by inserting an orifice plug into either or both of the sample line connectors to restrict the air flow. Cleveland Controls offers the **P/N 6171 Inline Orifice Kit** to deal with situations where there is no suitable orifice available to fit the sample line connectors on the sensing switch, or the need for the delayed switching action is discovered after the sensing switch has been installed and a convenient location for applying an orifice is needed.

The P/N 61371 Inline Orifice Kit includes one Straight Through Connector. It can hold one of the five different diameter orifices included in the kit, as shown in Table 1.

More information about applying orifice plugs to different types of sensing switches is available in the TB101504-2-XXX Effects of Air Flow Restriction on Air Switch Operation series of Technical Bulletins.

TABLE 1: ORIFICE SELECTION

PART NUMBER		COLOR	DIA.
25768-001		Gold	0.010
25768-002		Gray	0.016
25768-003		White	0.023
25768-004		Red	0.028
25768-005		Blue	0.035

2. INSTALLATION

1. **The Inline Orifice Kit can be installed on either or both sample lines.** To insert orifices into both sample lines, a separate kit is needed for each sample line because there is only one Straight Through Adapter in each kit.
2. Cut the flexible tubing line close to the switch, about 1" to 1-1/2" away from the sample line connector on the switch, allowing sufficient length for the connector on the fitting.
3. Insert one end of the Straight Through fitting to the open end of the tubing near the switch.
4. Insert one of the five included orifices into the other end of the Straight Through fitting and then reconnect it to the open end of the sample line. Note that the orifice is inserted into the end of the fitting further away from the switch.

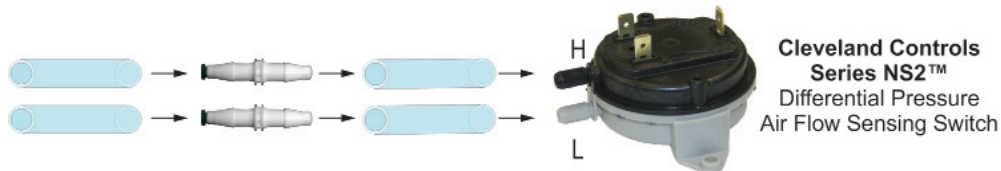
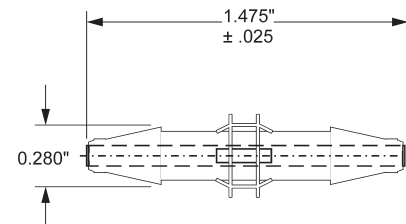

Cleveland Controls
DIVISION OF UNICONTROL INC.
1111 Brookpark Rd
Cleveland OH 44109

Tel: 216-398-0330

Fax: 216-398-8558

Email: salesvac@unicontrolinc.com

Web page: <http://www.clevelandcontrols.com>

Are you reading a FAX or a COPY of this bulletin? **DOWNLOAD** the full-color PDF version of this and other literature at our website!